

Lubetronic

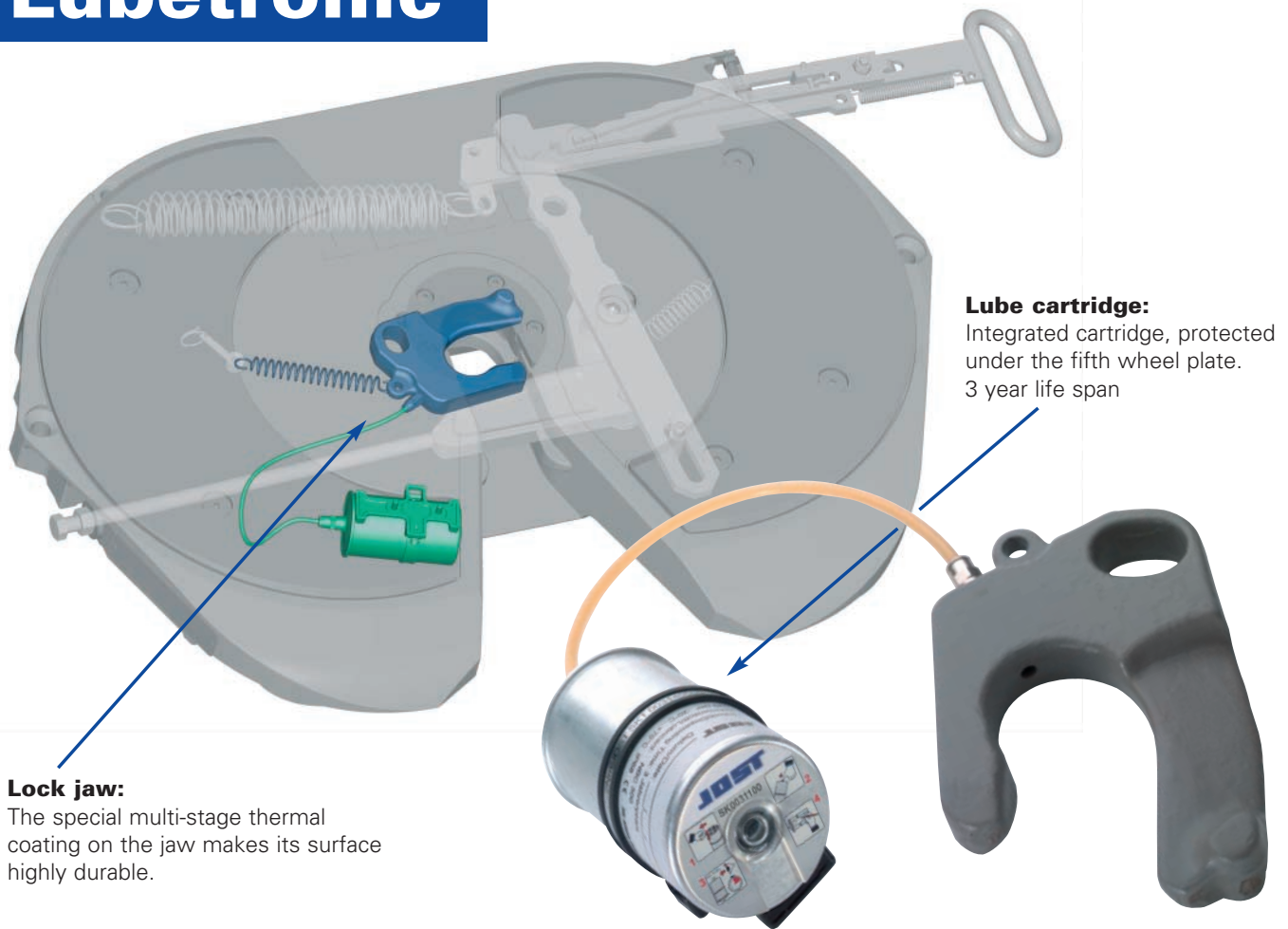

Lock jaw:

The special multi-stage thermal coating on the jaw makes its surface highly durable.

Lube cartridge:

Integrated cartridge, protected under the fifth wheel plate.
3 year life span

www.jost-world.com

Lubrication of the wheel coupling Guaranteed safe and automatic for 3 years

Always lubricates safely

- The special coating on the lock jaw makes the surface extremely durable. This allows the lock jaw to be operated with a minimal amount of lubricant.
- Excellent emergency running properties allow the coating to handle short-term operating even without lubricant.
- Outstanding lubrication qualities thanks to novel lubricants from high-performance grease and continuous lubrication
- Temperature range: -20°C to $+70^{\circ}\text{C}$
- Electronic dose dispensing reduces both costs and environmental impact
- Completely sealed and immersion tested (IP 68)

Simple Maintenance

- LubeTronic is easy to mount
- Self-regulating system with electronic monitoring signal on the cartridge
- Guaranteed 3 year life span
- Maintenance time savings
- Potential upgrading of all low-maintenance couplings
- Very light and compact
- With shockproof metal bracket
- Not recommended for usage in the construction industry
- Repair kit (complete) with cartridge:
Order No. SKE004070000

JUST

Products

Agricultural hitches

Towing hitches, trailer trestles, clutch carriers, towing eyes and accessories



VARIOBLOC

Multifunctional intermodal system for transporters, off-road vehicles and buses



Ball bearing turntables

Ball bearing turntables and slewing rings



Drawbars and drawbar eyes

Drawbars and drawbar eyes, different versions and special tailor-made models



Towing hitches

Towing hitches and hook trailer hitches, accessories, special versions

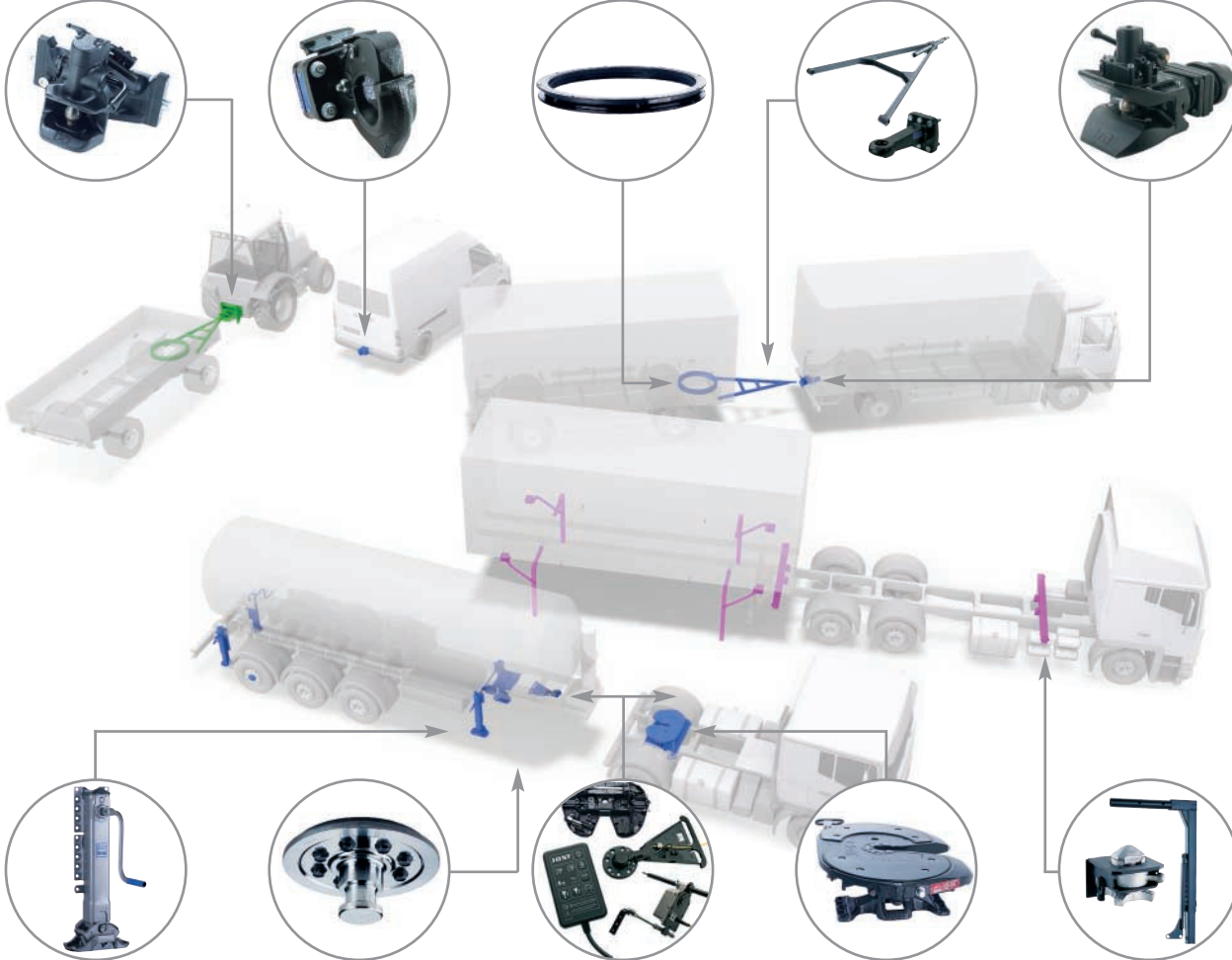

Modul landing gear

Variable mounting and bolting heights, crank handles and connection shaft lengths plus five foot types. Also available as special landing gear for specific applications



King pins

Various versions of the king pins are available in 2" and 3 1/2" for all systems



Systems

Sensor Coupling, SKS, KKS



Fifth wheel couplings

2" and 3 1/2", various mounting heights, bearing types and versions. Also in combination with sliders and dual height fifth wheel systems



Container equipment

Components for intermodal transports, supports, twist locks and bolsters, airbag lifting devices, guide rollers and bearings



More information regarding our range of products can be found at www.jost-world.com

